

50HZ



EXL-03,06



EXL-08,10,12,20

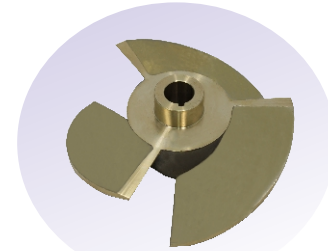

Axial-flow Impeller

### Performance Curves

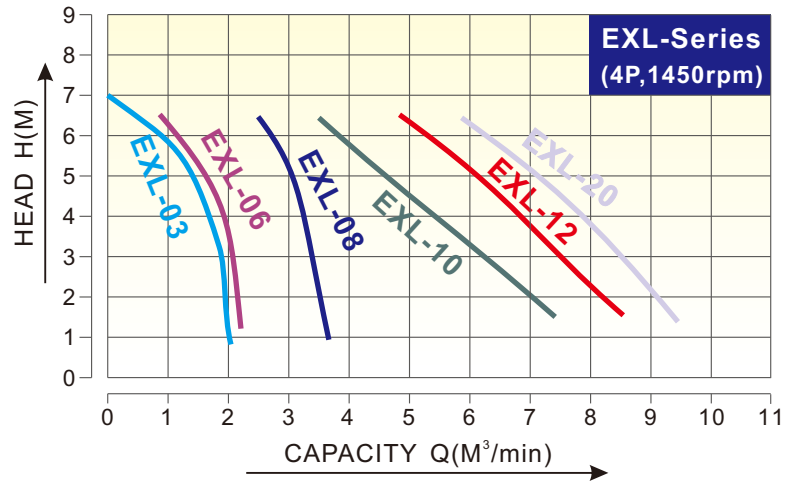

### Operating Conditions & Construction

Discharge diameter(mm)		150,200,250,300	
Liquid	Liquid temp.	0~40°C	
	Liquid nature	Irrigation, aquaculture water	
	Max. Depth	10M	
Pump	Structure	Impeller	Axial-flow type
		Mech. seal	Double mechanical seal
		Bearing	Ball type bearing(NSK)
	Material	Upper cover	FC200 or Bronze
		Impeller	Bronze
		Pump casing	FC200
Mech. seal	Carbon+Ceramic		
Motor	Type	Oil or Dry motor	
	Pole	4P	
	Insulation	F class	
	Frequency	60HZ	
	Material	Cable	VCT
		Main shaft	SUS304
		Frame	SUS304

### Features

- Big water capacity can be provided.
- Silent operation and almost no vibration during operation.
- Strong structure and compact design with oil motor, double mechanical seal, axial-flow impeller and guide vane for high efficiency components.
- Easy installation and dismantling, energy saving and low maintenance.

### Applications

- Water extracting from streams, lakes, reservoirs, fish ponds.
- Water supply and circulation for landscape and gardens.
- Aquaculture and agriculture pumping water and drainage for large volume capacity applications.
- Flood control.

### Specification & Dimensions

Model	Power		Discharge		Phase	Pole	Rated Head (M)	Rated Cap. (M³/min)	Max. Head (M)	Max. Cap. (M³/min)	Solid Passage (MM)	Net Weight (KG)	Dimensions (mm)		Cable (MM³xM)
	HP	KW	INCH	MM									Diagram	Height	
EXL-03	3	2.2	6"	150	3	4	6	0.96	7	2.0	290	70	290	740	3.3³X10
EXL-06	5	3.7	6"	150	3	4	6	0.90	6.5	2.0	230	70	270	740	5.5³x10
EXL-08	7.5	5.5	8"	200	3	4	6	1.92	6.5	3.5	340	120	325	920	5.5³x10
EXL-10	10	7.5	10"	250	3	4	6	3.30	6.5	7.5	370	180	360	1000	8.0³x10
EXL-12	15	11	12"	300	3	4	6	4.20	6.5	8.5	430	225	360	1080	14³x10
EXL-20	20	15	12"	300	3	4	6	8.50	6.5	9.5	430	236	460	1100	14³x10